

**TOWN OF SOUTHAMPTON: HISTORIC CEMETERY  
INVENTORY SHEET**

Survey File # HistCemFL3 Photo # Hubbard 001-005

Hamlet Flanders Town List No. n/a Acres 317.7

Street Address Rte. 24/Red Creek Road Section/Block/Lot/ 900-150-1-22

Common Name Hubbard Cemetery Status? inactive

Historic Name \_\_\_\_\_

Owner/Contact Person: Town of Southampton/Allyn F. Jackson, Superintendent,

Southampton Parks & Recreation Department ; Emily Oster, Town

Historian [contact/information only: #631-653-5205] and Richard Martin,

Director, Suffolk County Parks, Dept./Historic Services (631) 854-0987

Phone # (631) 728-8585 E-mail \_\_\_\_\_

Address 6 Newtown Lane, Hampton Bays,  
NY

Description: Prominent Features small, fenced graveyard; gravestones vandalized

# Headstones [approx] 8 DAR # n/a Date Range 19th c.

Stone Types marble & granite

Condition historic stones broken, dislocated

Miscellaneous Features replacement memorial tablet intact

Maintained by: Town? yes Other? \_\_\_\_\_

Date Recorded February 2004 Recorded By Z. Studenroth

References: Maps/Views \_\_\_\_\_

Published Sources New York State Cemeteries Name/Location Inventory

1995-1997 [p. 862]

# Hubbard Cemetery

## Southampton Historic Cemetery Inventory No. FL3

The 2001 digital orthophotography files are projected in the New York State Plane, NAD 83, Survey Feet projection, with a resolution of .5 feet, natural color film. Downloaded from the NYS GIS Clearinghouse.



# Hubbard Cemetery Southampton Historic Cemetery Inventory No. FL3

## Pattern of Key Conditions

If several conditions are present, the top (most serious or most remarkable) condition covers the polygon.

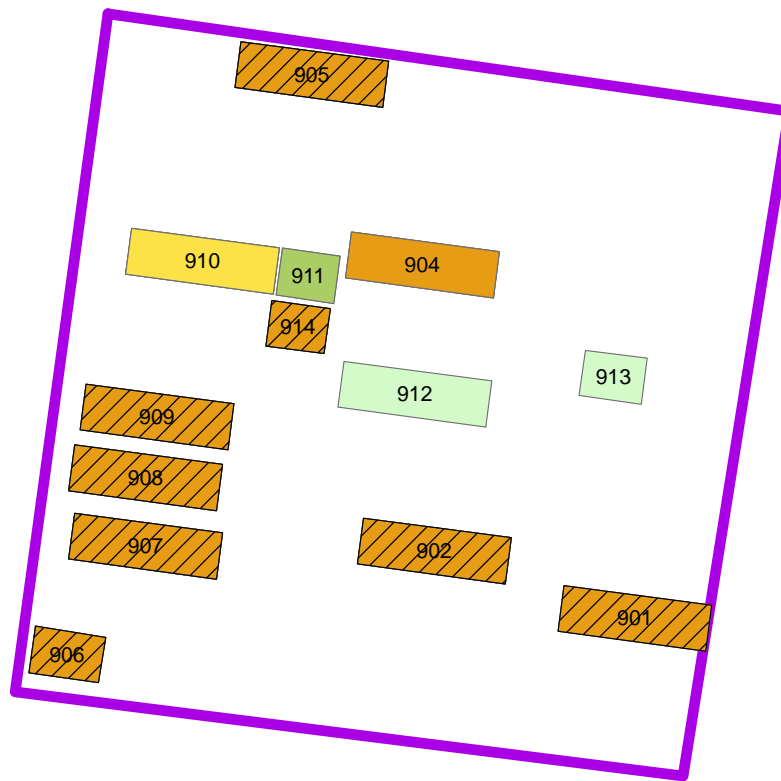

### Legend

- GroupPlots
- Detachment = 4
- Fragmentation > 2
- Mower = 2, 3, 4
- Disassembled > 2
- Tilted Fallen > 2
- Biogrowth > 2
- Buried > 2

Note: Placement and size of features is not to scale.

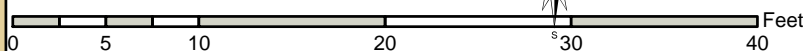

# Hubbard Cemetery Southampton Historic Cemetery Inventory No. FL3

## Distribution by Primary Marker Type

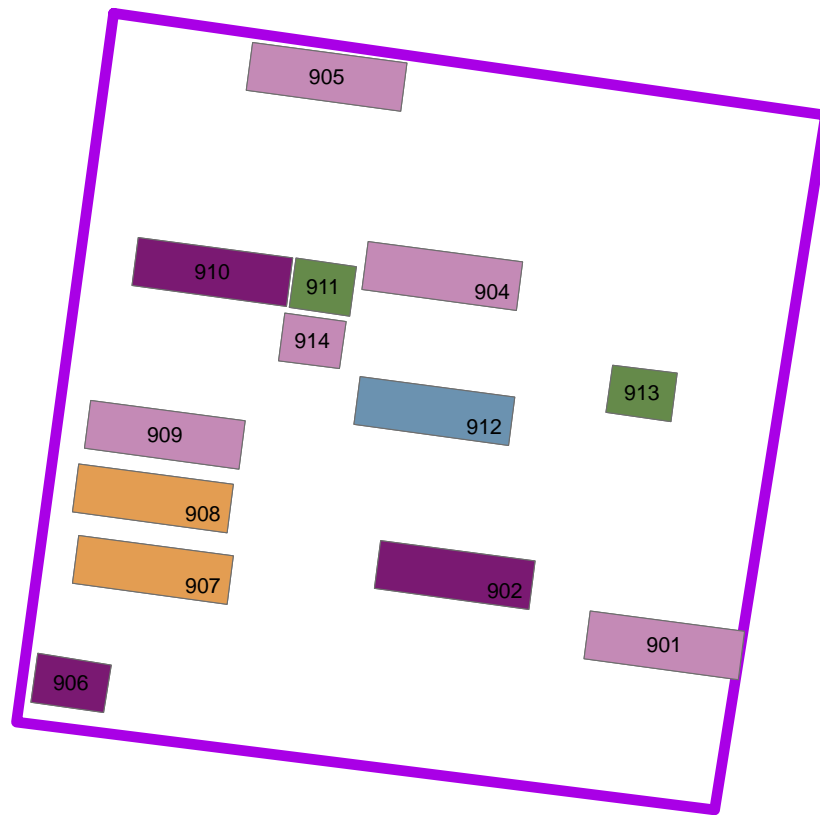

### Legend

- GroupPlots
- Other
- Headstone w/ Footstone
- Headstone w/o Footstone
- Headstone in Base w/ Footstone
- Headstone in Base
- Rectangular/Square Block
- Block on Base
- Only Footstone Remains

Note: Placement and size of features is not to scale.

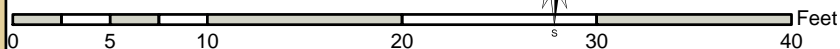

# Hubbard Cemetery Southampton Historic Cemetery Inventory No. FL3

## Distribution by Material of Primary Marker

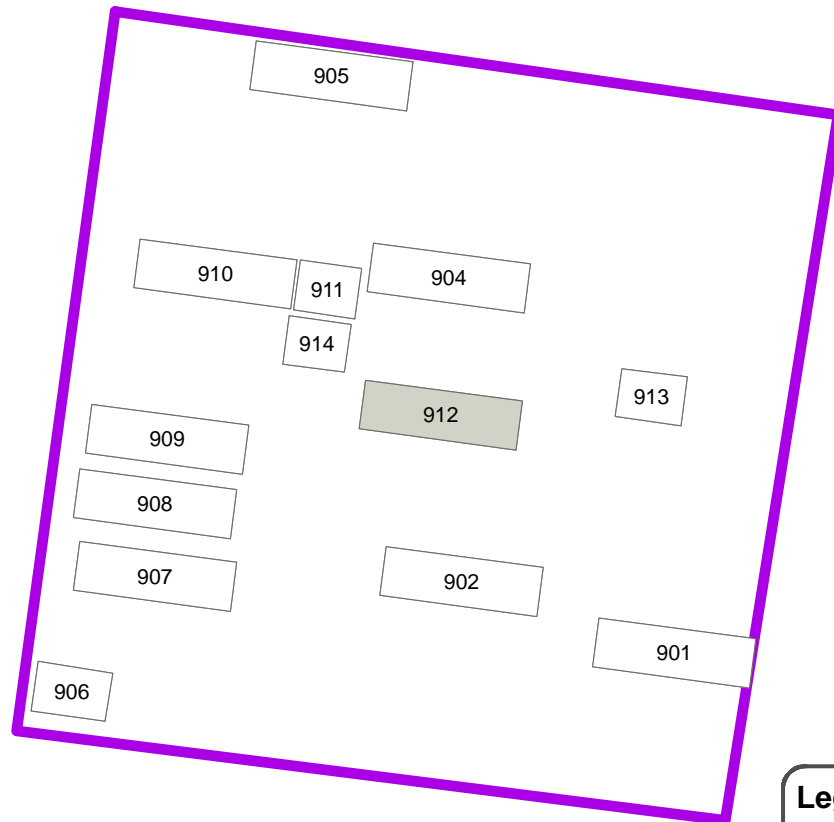

Note: Placement and size of features is not to scale.

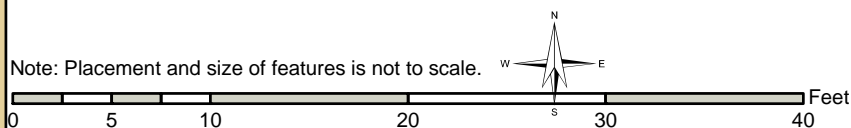

# Hubbard Cemetery Southampton Historic Cemetery Inventory No. FL3

## Distribution by First Death Date

